

LICENSING ACT 2003 SUB-COMMITTEE

WEDNESDAY 11 APRIL 2018

1.30 PM

Forli Room - Town Hall

AGENDA

Page No

1. **Apologies for Absence**

2. **Declarations of Interest**

At this point Members must declare whether they have a disclosable pecuniary interest, or other interest, in any of the items on the agenda, unless it is already entered in the register of members' interests or is a "pending notification " that has been disclosed to the Solicitor to the Council.

3. **Application for Premises Licence - Little Europe - 715 Lincoln Road, Peterborough, PE1 3HD** 3 - 38



There is an induction hearing loop system available in all meeting rooms. Some of the systems are infra-red operated, if you wish to use this system then please contact Karen Dunleavy on 01733 452233 as soon as possible.

Emergency Evacuation Procedure – Outside Normal Office Hours

In the event of the fire alarm sounding all persons should vacate the building by way of the nearest escape route and proceed directly to the assembly point in front of the Cathedral. The duty Beadle will assume overall control during any evacuation, however in the unlikely event the Beadle is unavailable, this responsibility will be assumed by the Committee Chair.

Recording of Council Meetings: Any member of the public may film, audio-record, take photographs and use social media to report the proceedings of any meeting that is open to the public. A protocol on this facility is available at:

<http://democracy.peterborough.gov.uk/documents/s21850/Protocol%20on%20the%20use%20of%20Recording.pdf>

Committee Members:

Councillors: Ayres (Chairman), Allen and B Saltmarsh

Further information about this meeting can be obtained from Karen Dunleavy on telephone 01733 452233 or by email – karen.dunleavy@peterborough.gov.uk



There is an induction hearing loop system available in all meeting rooms. Some of the systems are infra-red operated, if you wish to use this system then please contact Karen Dunleavy on 01733 452233 as soon as possible.

"Did you know? All Peterborough City Council's meeting agendas are available online or via the [modern.gov](https://www.modern.gov) app. Help us achieve our environmental protection aspirations and view this agenda online instead of printing it."

LICENSING ACT 2003 SUB COMMITTEE		AGENDA ITEM No. 3
11 APRIL 2018		PUBLIC REPORT
Contact Officers:	Kerry Leishman, Licensing & Business Manager Simon Andrews, Licensing Regulatory Officer	Tel: 453502 Tel. 453486

APPLICATION: NEW PREMISES LICENCE

APPLICANT: Little Europe

REFERENCE NO: 076866

PREMISES: 715 Lincoln Road, Peterborough, PE1 3HD

GLOSSARY OF TERMS: Attached at **Appendix A** on **Page 8**

1. PURPOSE OF REPORT

1.1 To consider and determine this application for a new premises licence for Little Europe 715 Lincoln Road, Peterborough, PE1 3HD taking into account the background information and representations received from ‘other persons’ in opposition of the application.

2. BACKGROUND INFORMATION

2.1.1 Since 18th April 2013 the Licensing Authority has adopted a special policy relating to the cumulative impact in respect to all licensed premises within the ‘Operation Can – Do’ area. An explanation of what this special policy entails can be found on page 10 of the Council’s Statement of Licensing Policy. A map showing the Can – Do area is attached at **Appendix C Page 35**

2.1.2 The premises falls within the ‘Operation Can – Do’ area and is therefore subject to the provisions of the special ‘cumulative impact’ policy.

3. AUTHORISATIONS AND TIMES APPLIED FOR

- **Sale of alcohol for consumption off the premises only**
Monday to Sunday 10am to 8pm
- **Opening hours of premises**
Monday to Sunday 10am to 10pm

4. APPLICATION

4.1 Please refer to the application attached at **Appendix B – Page 11**

- 4.2 A Representation against the application has been received from 1 ‘other persons’ the Chair of Millfield & New England Regeneration Partnership (MANERP). This is attached at **Appendix D on Page 37.**
- 4.3 Part P of the application sets out the applicant’s proposed conditions under the licensing objectives, these being, ‘The Prevention of Public Nuisance’, ‘Public Safety’, ‘Prevention of Crime and Disorder’ and ‘The Protection of Children from Harm’. These are also contained within the body of this report (in section 7) and in accordance with section 10.5 of Guidance have been interpreted into enforceable conditions. Only those appropriate and proportionate for the promotion of the licensing objectives have been included in the Operating Schedule.
- 4.4 No representations have been received from any of the Responsible Authorities i.e. Cambridgeshire Constabulary, Home Office, Peterborough Trading Standards, Public Health Authority, Cambridgeshire Fire and Rescue Service, Licensing Authority, Peterborough City Council Planning Department, Peterborough City Council Health & Safety Department, Peterborough City Council Environmental Pollution Team, or Children’s Services. There are no representations in support of the application.
- 4.5 A ‘Notice’ was displayed in the newspaper in accordance with Part 4 No. 25 of Statutory Instruments 2005 No. 42 – The licensing Act 2003 (Premises Licences and Club Premises Certificates) Regulations 2005.

5. REPRESENTATIONS

- 5.1 Summary of issues raised by ‘other persons’ objecting to the application:
- In ‘Op Can-do’ area which is now subject to a special ‘cumulative impact policy.
 - Another premises offering ‘Off Sales’ of alcohol would lead to an increase in anti-social behaviour in the vicinity.
- 5.2 There were no representations in support of the application.

6. MEDIATION

- 6.1 Mediation has not taken place.

7. APPLICANT’S PROPOSED CONDITIONS UNDER THE LICENSING OBJECTIVES:

7.1 Crime and disorder

These conditions have been carefully formulated to support the Licensing Objectives, taking into account the premises is located within the Cumulative Impact Area (CIA).

- Alcohol available for sale will be restricted between the hours of 10.00 until 20.00.
- All alcohol will be secured against public access with lockable storage areas, before and after permitted licensable hours.
- The Licensee will display at all times in close proximity to all alcohol displays within the premises, the current Alcohol guidelines produced by the Chief Medical Officers. (see attached – simple A4 poster).
- There will be no window display posters or similar advertising containing and reference to alcohol on the premises shop frontage or the highway abutting the premises.
- Spirits must be displayed and secured behind the sales point and will not be available for self-service.
- There will be no sales of beer lager, or cider over 6% ABV.
- The licence holder shall operate and maintain a refusals register in respect of declined sales of alcohol where the attempted purchaser was suspected of being under 18 years of age or drunk.

- The refusals register shall be kept on the premises and be made available immediately upon request to an authorised officer of the Police or Local Authority.
- The licence holder will ensure that within six weeks of any appointment of a member of staff, they receive adequate training in responsible alcohol retailing and refreshed every 12 months. A training record will be kept at the premises.
- No alcoholic drinks will be purchased by the store owners or staff from sellers calling at the store. All invoices (originals or copies) for all alcoholic goods for retail sale on the premises will be kept at the shop and made available to Police, Council and HMRC Officers upon request. An ultra-violet light will be available at the premises for the purpose of checking the UK Duty Stamp on all spirits as soon as practical after they have been purchased.
- If any spirits bought by the company have UK Duty Stamps that do not fluoresce under ultra-violet light, or are otherwise suspicious, the licensee shall identify the supplier to Trading Standards department and HMRC as soon as possible.
- A fully working and maintained CCTV system capable of recording and storing images must be installed on the premises. The system must record at all times the premises is open to the public and images must be stored for a minimum of 28 days with date & time stamping. As a minimum this must cover all entry and exit points, both sides of all areas where the sale/supply of alcohol takes place.
- All recordings must be made available to an officer from a responsible authority upon reasonable request and in line with the provisions of the Data Protection Act 1998.
- All staff involved in the retail of alcohol will be trained in relation to the law regarding its sale. This training must be completed prior to them being authorised to sell alcohol and refreshed every 12 months as a minimum. A record of this training must be kept and maintained with a copy of the syllabus attached. The recipient of the training must sign to state that they have received and understood the training and this should be dated. Training records must be kept on the premises at all times and made available to an officer from a responsible authority upon reasonable request.
- The premises will operate and adhere to an age verification scheme with the minimum standard of Challenge 25. Signs advertising the policy must be displayed in all areas where alcohol is for sale.
- A refusals register will be kept on the premises for the recording of any incidents involving the refusal of a sale of alcohol due to age or drunkenness. The register will be made available to an officer from the local authority for inspection upon reasonable request
- No person will be allowed to enter or leave the licensed premises with an open vessel of alcohol and the licensee will actively discourage and prevent anyone congregating or drinking outside the premises.

7.2 **Prevention of Public Nuisance**

- Persons shall be discouraged from congregating outside of the premises.
- A notice will be placed immediately outside the main entrance reminding persons that no alcohol to be consumed directly outside the main entrance to the shop.
- Waste collection contractors will not collect refuse between 23:00 and 07:00 hours. Any litter or refuse generated must be contained within the boundaries of the premises and regularly cleared (the boundaries of the premises are taken to be those indicated on the plan
- Receptacles for waste shall be emptied regularly to avoid causing a public nuisance through smells or odours and shall be maintained in a clean condition.
- Trade waste containers will only be left out for collection of waste on the day of collection and will be stored off the public right of way at all other times.

- Clear and legible notices will be prominently displayed at all exits asking customers to respect local residents and to leave the area quietly.

7.3 **Protection of children from harm**

- The challenge 25 scheme will be implemented
- To ensure that any person selling or supplying alcoholic drink under the authority of a personal licence holder follows the guidelines of the Challenge 25 scheme and asks for photo ID proof of age where they have reason to suspect that the individual may be under 25 years of age and to ensure that signs relevant to this condition are prominently displayed at the premises.

7.4 **Public Safety**

- The premises will conform to all statutory Health and Safety Requirements.

8. **POLICY & GUIDANCE IMPLICATIONS**

8.1 The following sections/paragraphs are applicable to this application:

8.2 **Council's Statement of Licensing Policy**

- Objectives, Section 4 on Page 7 and 8
- Fundamental Principles, Section 6 on Page 6 and 7
- Licence Conditions, Section 14 page 17
- Delegation / Decision Making / Administration, Section 17 on Page 19 and 20

8.3 **Guidance Issued under Section 182 of the Licensing Act 2003 April 2017**

- The Licensing Objectives – Section 2 pages 7 to 17
- Applications for Premises Licences – Section 8 pages 52 to 62
- Determining applications – Section 9 pages 70 to 78
- Conditions Attached to Premises Licences – Section 10 page 79 to 90

9. **LICENSING OFFICER'S COMMENT (FOR INFORMATION)**

9.1 Regulation 19(a) requires authorities to disregard any information given by a party or person that is “not relevant” to the application.

9.2 Members should note that the letters and emails attached are in their entirety and that not all matters raised within the representations are relevant matters for consideration under the Licensing Act 2003. It is up to the Committee to decide upon what ‘weight’ they attach to these areas.

10. **LEGAL OFFICER'S COMMENTS**

10.1 The Licensing Authority (hereafter referred to as “the Council) is charged with implementing the provisions of the Licensing Act 2003. This is an application for a new licence made under Section 17 of the Licensing Act.

10.2 In this case, the application was received at these offices on 19 February 2018.

10.3 The application before this committee will be treated on its own merits, and the Licensing committee will make its decision based upon:

- The merits of the application;
- The promotion of the four licensing objectives;
- The statement of policy of the Licensing Authority; and
- The Guidance issued by the Secretary of State for Culture, Media and Sport under section 182 of the Licensing Act 2003 – October 2014.

- 10.4 The licensing authority may determine the application, depending upon what is appropriate for the promotion of the licensing objectives, in any of the following ways:
- Decide to grant the licence in the same terms as it was applied for;
 - Decide to grant the licence, but to modify or add conditions (to promote the licensing objectives);
 - Exclude from the scope of the licence a licensable activity; and
 - Decide to refuse to grant the licence.
- 10.5 Conditions are modified if they are altered, omitted or any new condition added (Section 35(4) Licensing Act 2003).

APPENDIX A

LICENSING ACT 2003

GLOSSARY OF TERMS

Note: In this document, the following definitions are included to provide an explanation of certain terms included in the Act. In some cases they are an abbreviation of what is stated in the Licensing Act 2003 or an interpretation of those terms. For a full definition of the terms used, the reader must refer to the Licensing Act 2003.

'Child'

(a) means an individual aged under 16

(b) a child is unaccompanied if he is not in the company of an individual aged 18 years or over

DCMS: Department for Culture Media and Sport

'Designated Premises Supervisor' means the person (who must be a Personal Licence Holder), in the case of premises selling alcohol, who will normally have been given the day to day responsibility for running the premises by the holder of the Premises Licence or will be the Premises Licence holder.

'Other Persons':

- persons who live, or are involved in a business, in the relevant licensing Authorities area and who are likely to be affected by the application and are not a Responsible Authority.

'Late Night Refreshment' means the supply of hot food or hot drink to members of the public (whether for consumption on or off the premises) between the hours of 11.00 pm and 5.00 am.

'Licensable Activities' means: -

- The sale by retail of alcohol
- The supply of alcohol by or on behalf of a club to, or to the order of, a member of the club
- The provision of Regulated Entertainment
- The provision of Late Night Refreshment

'Licensing Authority': - is the licensing function of Peterborough City Council

'Licensed Premises' includes club premises and events unless the context otherwise requires.

'Licensing Objectives'

- The prevention of crime and disorder
- Public safety
- The prevention of public nuisance
- The protection of children from harm

'Operating Schedule' means a document containing a statement of the following matters (and any others that may be prescribed): -

- The relevant Licensable Activities
- The times at which the Licensable Activities are to take place and any other times when premises are open to the public
- Information regarding the person who will be specified in the Premises Licence as the Premises Supervisor
- Where the Licensable Activities involve the supply of alcohol, whether it is for the supply on and/or off the premises
- The steps being taken to promote the Licensing Objectives

'Challenge 25' means that a retailer will ask for proof of identification if they have reason to believe that the person making a purchase of alcohol is under the age of 25.

‘Rateable Value’: as regards a premises, is the value for the time being in force for the premises entered in the local non-domestic rating list for the purposes of Part III of the Local Government Finance Act 1988(b).

‘Regulated Entertainment’ (Schedule 1 of the Act) means: -

- A performance of a play
- An exhibition of a film
- An indoor sporting event
- A boxing or wrestling entertainment
- A performance of live music
- Any playing of recorded music
- A performance of dance

Except where there is an exemption under the Live Music Act 2012 or Statutory Instrument 2013 No. 1578 The Licensing Act 2003 (Descriptions of Entertainment) (Amendment) Order 2013

Or entertainment of a similar description falling within the last three of the categories listed above, where the entertainment takes place in the presence of and for the purposes of entertaining that audience or spectators.

‘Relevant Licensing Authority’: is the Authority in the area the premises are situated.

‘Responsible Authority’ means any of the following: -

- Cambridgeshire Constabulary (The Chief Officer of Police)
- Cambridgeshire Fire and Rescue (The Fire Authority)
- Health and Safety Team, Peterborough City Council
- Planning authority, Peterborough City Council
- Trading Standards, Peterborough City Council
- Environmental Health – Pollution, Peterborough City Council
- Children’s Services – Child Protection & Review Manager
- Primary Care Trust or Local Health Board (Director of Public Health)
- The Relevant Licensing Authority, Peterborough City Council
- Maritime & Coastguard Agency, Walton on Naze. (For vessels carrying more than 12 passengers.)
- Environment Agency, Peterborough (For vessels carrying 12 or less passengers).

‘Supply of alcohol’:

- the sale by retail of alcohol, or
- the supply of alcohol by or on behalf of a club to, or to the order of, a member of the club.

‘Temporary Event Notice’ means a Permitted Temporary Activity involving one or more Licensable Activities subject to the following various conditions and limitations: -

- Duration – they are limited to events lasting for up to 168 hours (7 days);
- Scale – they cannot involve the presence of more than 499 people at any one time;
- Use of the same premises – the same premises cannot be used on more than 12 occasions in a calendar year, but are subject to the overall aggregate of 21 days irrespective of the number of occasions on which they have been used; and
- The number of notices given by an individual within a given period of time – a Personal Licence Holder is limited to 50 notices in one year and another person to 5 notices in a similar period.

(In any other circumstances, a full Premises Licence or Club Premises Certificate will be required for the period of the event).

‘the Act’: means the Licensing Act 2003

This page is intentionally left blank

19 FEB 2018

LICENSING

**Application for a premises licence to be granted
under the Licensing Act 2003**

PLEASE READ THE FOLLOWING INSTRUCTIONS FIRST

Before completing this form please read the guidance notes at the end of the form. If you are completing this form by hand please write legibly in block capitals. In all cases ensure that your answers are inside the boxes and written in black ink. Use additional sheets if necessary.

You may wish to keep a copy of the completed form for your records.

I/we TAHA RASHED HASSAN
(Insert name(s) of applicant)

apply for a premises licence under section 17 of the Licensing Act 2003 for the premises described in Part 1 below (the premises) and I/we are making this application to you as the relevant licensing authority in accordance with section 12 of the Licensing Act 2003

Part 1 – Premises details

Postal address of premises or, if none, ordnance survey map reference or description			
LITTLE EUROPE 715. LINCOLN ROAD			
Post town	PETERBOROUGH.	Postcode	PE1 3HD

Telephone number at premises (if any)	
Non-domestic rateable value of premises	£ 7,400 Band B

Part 2 - Applicant details

Please state whether you are applying for a premises licence as Please tick as appropriate

- a) an individual or individuals * please complete section (A)
- b) a person other than an individual *
 - i as a limited company/limited liability partnership please complete section (B)
 - ii as a partnership (other than limited liability) please complete section (B)
 - iii as an unincorporated association or please complete section (B)
 - iv other (for example a statutory corporation) please complete section (B)
- c) a recognised club please complete section (B)
- d) a charity please complete section (B)

- e) the proprietor of an educational establishment please complete section (B)
- f) a health service body please complete section (B)
- g) a person who is registered under Part 2 of the Care Standards Act 2000 (c14) in respect of an independent hospital in Wales please complete section (B)
- ga) a person who is registered under Chapter 2 of Part 1 of the Health and Social Care Act 2008 (within the meaning of that Part) in an independent hospital in England please complete section (B)
- h) the chief officer of police of a police force in England and Wales please complete section (B)

* If you are applying as a person described in (a) or (b) please confirm (by ticking yes to one box below):

- I am carrying on or proposing to carry on a business which involves the use of the premises for licensable activities; or
- I am making the application pursuant to a
 - statutory function or
 - a function discharged by virtue of Her Majesty's prerogative

(A) INDIVIDUAL APPLICANTS (fill in as applicable)

Mr <input checked="" type="checkbox"/>	Mrs <input type="checkbox"/>	Miss <input type="checkbox"/>	Ms <input type="checkbox"/>	Other Title (for example, Rev)
Surname HASSAN		First names TAHA RASHED		
Date of birth [REDACTED]		m 18 years old or over <input checked="" type="checkbox"/> Please tick yes		
Nationality [REDACTED]				
Current residential address if different from premises address		[REDACTED] WOODSON P/BORO		
Post town	PETERBOROUGH		Postcode	PE2 9QE
Daytime contact telephone number				
E-mail address (optional)				

SECOND INDIVIDUAL APPLICANT (if applicable)

Mr <input type="checkbox"/>	Mrs <input type="checkbox"/>	Miss <input type="checkbox"/>	Ms <input type="checkbox"/>	Other Title (for example, Rev)
Surname		First names		

Date of birth		I am 18 years old or over <input type="checkbox"/> Please tick yes	
Nationality			
Current residential address if different from premises address			
Post town		Postcode	
Daytime contact telephone number			
E-mail address (optional)			

(B) OTHER APPLICANTS

Please provide name and registered address of applicant in full. Where appropriate please give any registered number. In the case of a partnership or other joint venture (other than a body corporate), please give the name and address of each party concerned.

Name
Address
Registered number (where applicable)
Description of applicant (for example, partnership, company, unincorporated association etc.)
Telephone number (if any)
E-mail address (optional)

Part 3 Operating Schedule

When do you want the premises licence to start?

DD	MM	YYYY
<input type="text"/>	<input type="text"/>	<input type="text"/>

If you wish the licence to be valid only for a limited period, when do you want it to end?

DD MM YYYY
20 03 20 18

Please give a general description of the premises (please read guidance note 1)

INTERNATIONAL GROCERY STORE LICENSED TO SELL ALCOHOL.

If 5,000 or more people are expected to attend the premises at any one time, please state the number expected to attend.

What licensable activities do you intend to carry on from the premises?

(please see sections 1 and 14 and Schedules 1 and 2 to the Licensing Act 2003)

Provision of regulated entertainment (please read guidance note 2)

Please tick all that apply

- a) plays (if ticking yes, fill in box A)
- b) films (if ticking yes, fill in box B)
- c) indoor sporting events (if ticking yes, fill in box C)
- d) boxing or wrestling entertainment (if ticking yes, fill in box D)
- e) live music (if ticking yes, fill in box E)
- f) recorded music (if ticking yes, fill in box F)
- g) performances of dance (if ticking yes, fill in box G)
- h) anything of a similar description to that falling within (e), (f) or (g) (if ticking yes, fill in box H)

Provision of late night refreshment (if ticking yes, fill in box I)

Supply of alcohol (if ticking yes, fill in box J)



In all cases complete boxes K, L and M

A

Plays Standard days and timings (please read guidance note 7)			Will the performance of a play take place indoors or outdoors or both – please tick (please read guidance note 3)	Indoors	<input type="checkbox"/>
				Outdoors	<input type="checkbox"/>
				Both	<input type="checkbox"/>
Day	Start	Finish	Please give further details here (please read guidance note 4)		
Mon					
Tue			State any seasonal variations for performing plays (please read guidance note 5)		
Wed					
Thur			Non standard timings. Where you intend to use the premises for the performance of plays at different times to those listed in the column on the left, please list (please read guidance note 6)		
Fri					
Sat					
Sun					

B

Films Standard days and timings (please read guidance note 7)			Will the exhibition of films take place indoors or outdoors or both – please tick (please read guidance note 3)	Indoors	<input type="checkbox"/>
				Outdoors	<input type="checkbox"/>
				Both	<input type="checkbox"/>
Day	Start	Finish			
Mon			Please give further details here (please read guidance note 4)		
Tue					
Wed			State any seasonal variations for the exhibition of films (please read guidance note 5)		
Thur					
Fri			Non standard timings. Where you intend to use the premises for the exhibition of films at different times to those listed in the column on the left, please list (please read guidance note 6)		
Sat					
Sun					

C

Indoor sporting events Standard days and timings (please read guidance note 7)			<u>Please give further details</u> (please read guidance note 4)
Day	Start	Finish	
Mon			<u>State any seasonal variations for indoor sporting events</u> (please read guidance note 5)
Tue			
Wed			
Thur			<u>Non standard timings. Where you intend to use the premises for indoor sporting events at different times to those listed in the column on the left, please list</u> (please read guidance note 6)
Fri			
Sat			
Sun			

D

Boxing or wrestling entertainments Standard days and timings (please read guidance note 7)			Will the boxing or wrestling entertainment take place indoors or outdoors or both – please tick (please read guidance note 3)	Indoors	<input type="checkbox"/>			
				Outdoors	<input type="checkbox"/>			
				Both	<input type="checkbox"/>			
Day	Start	Finish	Please give further details here (please read guidance note 4)					
Mon								
Tue								
Wed						State any seasonal variations for boxing or wrestling entertainment (please read guidance note 5)		
Thur								
Fri								
Sat						Non standard timings. Where you intend to use the premises for boxing or wrestling entertainment at different times to those listed in the column on the left, please list (please read guidance note 6)		
Sun								

E

Live music Standard days and timings (please read guidance note 7)			Will the performance of live music take place indoors or outdoors or both – please tick (please read guidance note 3)	Indoors	<input type="checkbox"/>			
				Outdoors	<input type="checkbox"/>			
				Both	<input type="checkbox"/>			
Day	Start	Finish	Please give further details here (please read guidance note 4)					
Mon								
Tue								
Wed						State any seasonal variations for the performance of live music (please read guidance note 5)		
Thur								
Fri						Non standard timings. Where you intend to use the premises for the performance of live music at different times to those listed in the column on the left, please list (please read guidance note 6)		
Sat								
Sun								

F

Recorded music Standard days and timings (please read guidance note 7)			Will the playing of recorded music take place indoors or outdoors or both – please tick (please read guidance note 3)		Indoors	<input type="checkbox"/>
					Outdoors	<input type="checkbox"/>
					Both	<input type="checkbox"/>
Day	Start	Finish				
Mon			Please give further details here (please read guidance note 4)			
Tue						
Wed			State any seasonal variations for the playing of recorded music (please read guidance note 5)			
Thur						
Fri			Non standard timings. Where you intend to use the premises for the playing of recorded music at different times to those listed in the column on the left, please list (please read guidance note 6)			
Sat						
Sun						

G

Performances of dance Standard days and timings (please read guidance note 7)			Will the performance of dance take place indoors or outdoors or both – please tick (please read guidance note 3)	Indoors	<input type="checkbox"/>			
				Outdoors	<input type="checkbox"/>			
				Both	<input type="checkbox"/>			
Day	Start	Finish	Please give further details here (please read guidance note 4)					
Mon								
Tue								
Wed						State any seasonal variations for the performance of dance (please read guidance note 5)		
Thur								
Fri						Non standard timings. Where you intend to use the premises for the performance of dance at different times to those listed in the column on the left, please list (please read guidance note 6)		
Sat								
Sun								

H

Anything of a similar description to that falling within (e), (f) or (g) Standard days and timings (please read guidance note 7)			Please give a description of the type of entertainment you will be providing		
Day	Start	Finish	Will this entertainment take place indoors or outdoors or both – please tick (please read guidance note 3)	Indoors	<input type="checkbox"/>
Mon				Outdoors	<input type="checkbox"/>
				Both	<input type="checkbox"/>
Tue			Please give further details here (please read guidance note 4)		
Wed					
Thur			State any seasonal variations for entertainment of a similar description to that falling within (e), (f) or (g) (please read guidance note 5)		
Fri					
Sat			Non standard timings. Where you intend to use the premises for the entertainment of a similar description to that falling within (e), (f) or (g) at different times to those listed in the column on the left, please list (please read guidance note 6)		
Sun					

I

Late night refreshment Standard days and timings (please read guidance note 7)			Will the provision of late night refreshment take place indoors or outdoors or both – please tick (please read guidance note 3)	Indoors	<input type="checkbox"/>
				Outdoors	<input type="checkbox"/>
				Both	<input type="checkbox"/>
Day	Start	Finish			
Mon			Please give further details here (please read guidance note 4)		
Tue					
Wed			State any seasonal variations for the provision of late night refreshment (please read guidance note 5)		
Thur					
Fri			Non standard timings. Where you intend to use the premises for the provision of late night refreshment at different times, to those listed in the column on the left, please list (please read guidance note 6)		
Sat					
Sun					

J

Supply of alcohol Standard days and timings (please read guidance note 7)			Will the supply of alcohol be for consumption – please tick (please read guidance note 8)	On the premises	<input type="checkbox"/>
				Off the premises	<input checked="" type="checkbox"/>
				Both	<input type="checkbox"/>
Day	Start	Finish	State any seasonal variations for the supply of alcohol (please read guidance note 5)		
Mon	10 ⁰⁰	22⁰⁰ 20 ⁰⁰			
Tue	10 ⁰⁰	22⁰⁰ 20 ⁰⁰			
Wed	10 ⁰⁰	22⁰⁰ 20 ⁰⁰			
Thur	10 ⁰⁰	22⁰⁰ 20 ⁰⁰			
Fri	10 ⁰⁰	22⁰⁰ 20 ⁰⁰			
Sat	10 ⁰⁰	22⁰⁰ 20 ⁰⁰			
Sun	10 ⁰⁰	22⁰⁰ 20 ⁰⁰			
			Non standard timings. Where you intend to use the premises for the supply of alcohol at different times to those listed in the column on the left, please list (please read guidance note 6)		

State the name and details of the individual whom you wish to specify on the licence as designated premises supervisor (Please see declaration about the entitlement to work in the checklist at the end of the form):

Name	TAHA RASHED HASSAN	
Date of	[REDACTED]	
Address	[REDACTED] WOODSON PETERBOROUGH.	
Postcode	PE2 9QE.	
Personal licence number (if known)	TBA.	
Issuing licensing authority (if known)	TBA.	

□□□□

K

Please highlight any adult entertainment or services, activities, other entertainment or matters ancillary to the use of the premises that may give rise to concern in respect of children (please read guidance note 9).

NONE

L

Hours premises are open to the public Standard days and timings (please read guidance note 7)			State any seasonal variations (please read guidance note 5)
Day	Start	Finish	
Mon	20⁰⁰ 10 ⁰⁰	22 ⁰⁰	Non standard timings. Where you intend the premises to be open to the public at different times from those listed in the column on the left, please list (please read guidance note 6)
Tue	10 ⁰⁰	22 ⁰⁰	
Wed	10 ⁰⁰	22 ⁰⁰	
Thur	10 ⁰⁰	22 ⁰⁰	
Fri	10 ⁰⁰	22 ⁰⁰	
Sat	10 ⁰⁰	22 ⁰⁰	
Sun	10 ⁰⁰	22 ⁰⁰	

M Describe the steps you intend to take to promote the four licensing objectives:

a) General – all four licensing objectives (b, c, d and e) (please read guidance note 10)

SEE ATTACHED APPENDIX

b) The prevention of crime and disorder

SEE ATTACHED APPENDIX

c) Public safety

SEE ATTACHED APPENDIX

d) The prevention of public nuisance

SEE ATTACHED APPENDIX

e) The protection of children from harm

P10.

SEE ATTACHED APPENDIX

Checklist:

Please tick to indicate agreement

- I have made or enclosed payment of the fee.
- I have enclosed the plan of the premises.
- I have sent copies of this application and the plan to responsible authorities and others where applicable.
- I have enclosed the consent form completed by the individual I wish to be designated premises supervisor, if applicable.
- I understand that I must now advertise my application.
- I understand that if I do not comply with the above requirements my application will be rejected.
-

[Applicable to all individual applicants, including those in a partnership which is not a limited liability partnership, but not companies or limited liability partnerships] I have included documents demonstrating my entitlement to work in the United Kingdom (please read note 15).

IT IS AN OFFENCE, UNDER SECTION 158 OF THE LICENSING ACT 2003, TO MAKE A FALSE STATEMENT IN OR IN CONNECTION WITH THIS APPLICATION. THOSE WHO MAKE A FALSE STATEMENT MAY BE LIABLE ON SUMMARY CONVICTION TO A FINE OF ANY AMOUNT.

IT IS AN OFFENCE UNDER SECTION 24B OF THE IMMIGRATION ACT 1971 FOR A PERSON TO WORK WHEN THEY KNOW, OR HAVE REASONABLE CAUSE TO BELIEVE, THAT THEY ARE DISQUALIFIED FROM DOING SO BY REASON OF THEIR IMMIGRATION STATUS. THOSE WHO EMPLOY AN ADULT WITHOUT LEAVE OR WHO IS SUBJECT TO CONDITIONS AS TO EMPLOYMENT WILL BE LIABLE TO A CIVIL PENALTY UNDER SECTION 15 OF THE IMMIGRATION, ASYLUM AND NATIONALITY ACT 2006 AND PURSUANT TO SECTION 21 OF THE SAME ACT, WILL BE COMMITTING AN OFFENCE WHERE THEY DO SO IN THE KNOWLEDGE, OR WITH REASONABLE CAUSE TO BELIEVE, THAT THE EMPLOYEE IS DISQUALIFIED.

Part 4 – Signatures (please read guidance note 11)

Signature of applicant or applicant’s solicitor or other duly authorised agent (see guidance note 12). **If signing on behalf of the applicant, please state in what capacity.**

Declaration	<ul style="list-style-type: none"> [Applicable to individual applicants only, including those in a partnership which is not a limited liability partnership] I understand I am not entitled to be issued with a licence if I do not have the entitlement to live and work in the UK (or if I am subject to a condition preventing me from doing work relating to the carrying on of a licensable activity) and that my licence will become invalid if I cease to be entitled to live and work in the UK (please read guidance note 15). The DPS named in this application form is entitled to work in the UK (and is not subject to conditions preventing him or her from doing work relating to a licensable activity) and I have seen a copy of his or her proof of entitlement to work, if appropriate (please see note 15)
Signature	[REDACTED]
Date	5-2-2018
Capacity	BUSINESS OWNER.

For joint applications, signature of 2nd applicant or 2nd applicant's solicitor or other authorised agent (please read guidance note 13). **If signing on behalf of the applicant, please state in what capacity.**

Signature	
Date	
Capacity	

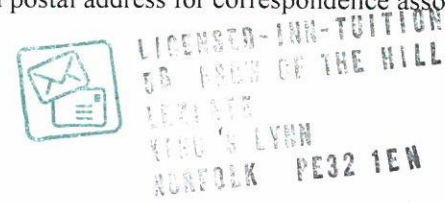
Contact name (where not previously given) and postal address for correspondence associated with this application (please read guidance note 14)			
			
Post town		Postcode	
Telephone number (if any)	01553 630993	07704 65 64 69	
If you would prefer us to correspond with you by e-mail, your e-mail address (optional)			
licensedinn@btinternet.com			

Notes for Guidance

- Describe the premises, for example the type of premises, its general situation and layout and any other information which could be relevant to the licensing objectives. Where your application includes off-supplies of alcohol and you intend to provide a place for consumption of these off-supplies, you must include a description of where the place will be and its proximity to the premises.
- In terms of specific regulated entertainments please note that:

APPENDIX

'Little Europe' 715 Lincoln Road, Peterborough, PE1 3HD

Shop PROPOSED Conditions:

Please find listed below conditions which 'Little Europe' would agree to be added to the premise licence, should it be granted. These conditions have been carefully formulated to support the Licensing Objectives, **taking into account the premises is located within the Cumulative Impact Area (CIA).**

Part M

Describe the steps you intend to take to promote the four licensing objectives

a) General – All Four Licensing objectives, (b,c,d and e)

- **Alcohol available for sale will be restricted between the hours of 10.00 until 20.00.**
- **All alcohol will be secured against public access with lockable storage areas, before and after permitted licensable hours.**
- The Licensee will display at all times in close proximity to all alcohol displays within the premises, the current Alcohol guidelines produced by the Chief Medical Officers. (see attached – simple A4 poster).
- **There will be no window display posters or similar advertising containing and reference to alcohol on the premises shop frontage or the highway abutting the premises.**
- Spirits must be displayed and secured behind the sales point and will not be available for self-service.
- **There will be no sales of beer lager, or cider over 6% ABV.**
- The licence holder shall operate and maintain a refusals register in respect of declined sales of alcohol where the attempted purchaser was suspected of being under 18 years of age or drunk.
- The refusals register shall be kept on the premises and be made available immediately upon request to an authorised officer of the Police or Local Authority.
- The licence holder will ensure that within six weeks of any appointment of a member of staff, they receive adequate training in responsible alcohol retailing and refreshed every 12 months. A training record will be kept at the premises.
- No alcoholic drinks will be purchased by the store owners or staff from sellers calling at the store. All invoices (originals or copies) for all alcoholic goods for retail sale on the premises will be kept at the shop and made available to Police, Council and HMRC Officers upon request. An ultra-violet light will be available at the premises for the purpose of checking the UK Duty Stamp on all spirits as soon as practical after they have been purchased.
- If any spirits bought by the company have UK Duty Stamps that do not fluoresce under ultra-violet light, or are otherwise suspicious, the licensee shall identify the supplier to Trading Standards department and HMRC as soon as possible.

b) The prevention of crime and disorder

- A fully working and maintained CCTV system capable of recording and storing images must be installed on the premises. The system must record at all times the premises is open to the public and images must be stored for a minimum of 28 days with date & time stamping. As a minimum this must cover all entry and exit points, both sides of all areas where the sale/supply of alcohol takes place.
- All recordings must be made available to an officer from a responsible authority upon reasonable request and in line with the provisions of the Data Protection Act 1998.
- All staff involved in the retail of alcohol will be trained in relation to the law regarding its sale. This training must be completed prior to them being authorised to sell alcohol and refreshed every 12 months as a minimum. A record of this training must be kept and maintained with a copy of the syllabus attached. The recipient of the training must sign to state that they have received and understood the training and this should be dated. Training records must be kept on the premises at all times and made available to an officer from a responsible authority upon reasonable request.
- The premises will operate and adhere to an age verification scheme with the minimum standard of Challenge 25. Signs advertising the policy must be displayed in all areas where alcohol is for sale.
- A refusals register will be kept on the premises for the recording of any incidents involving the refusal of a sale of alcohol due to age or drunkenness. The register will be made available to an officer from the local authority for inspection upon reasonable request
- No person will be allowed to enter or leave the licensed premises with an open vessel of alcohol and the licensee will actively discourage and prevent anyone congregating or drinking outside the premises.

c) Public Safety

- The premises will conform to all statutory Health and Safety Requirements

d) The prevention of public nuisance

- Persons shall be discouraged from congregating outside of the premises.
- A notice will be placed immediately outside the main entrance reminding persons that no alcohol to be consumed directly outside the main entrance to the shop.
- Waste collection contractors will not collect refuse between 23:00 and 07:00 hours. Any litter or refuse generated must be contained within the boundaries of the premises and regularly cleared (the boundaries of the premises are taken to be those indicated on the plan
- Receptacles for waste shall be emptied regularly to avoid causing a public nuisance through smells or odours and shall be maintained in a clean condition.
- Trade waste containers will only be left out for collection of waste on the day of collection and will be stored off the public right of way at all other times.
- Clear and legible notices will be prominently displayed at all exits asking customers to respect local residents and to leave the area quietly.

e) The protection of Children from harm

- The challenged 25 scheme will be implemented
- To ensure that any person selling or supplying alcoholic drink under the authority of a personal licence holder follows the guidelines of the Challenge 25 scheme and asks for photo ID proof of age where they have reason to suspect that the individual may be under 25 years of age and to ensure that signs relevant to this condition are prominently displayed at the premises.

Sunday	10:00	-	20:00
Monday	10:00	-	20:00
Tuesday	10:00	-	20:00
Wednesday	10:00	-	20:00
Thursday	10:00	-	20:00
Friday	10:00	-	20:00
Saturday	10:00	-	20:00
Non Standard Timings / Seasonal Variations			

New Government Alcohol Guidelines for Men & Women

You shouldn't regularly drink more than

14 units a week



This means you **should not drink more than** this amount of **wine** ...

175ml
glasses of
13% wine



...**OR** this amount of **lager or ale**

568ml
pints of 4%
lager or ale



...**OR** this amount of **cider**

568ml
pints of
4.5% cider



...**OR** this amount of **spirits**

25ml
glasses of
40% spirits



LICENSING ACT 2003

Blue notice
Copy

NOTICE OF APPLICATION FOR A PREMISES LICENCE

Notice is given that Taha Rashed Hassan has on the 19 February 2018, applied to Peterborough City Council as the Licensing Authority for the grant of a Premises Licence in respect of;

'Little Europe', 715 Lincoln Road, Peterborough, PE1 3HD

To permit:

Sale of alcohol (<i>for consumption off the premises</i>)	Mon – Sun	1000hr – 2000hrs
---	-----------	------------------

Anyone wishing to make representations concerning this application should do so in writing to: The Licensing Team, Peterborough City Council, 1st Floor Bayard Place, Peterborough, PE1 1FB.

Representations in respect of this application must reach the Licensing Authority by 19TH March 2018.

Persons wishing to inspect the register or the record of this application may do so by attending by appointment the office of the Licensing Section, during office hours, Monday to Friday inclusive.

It is an offence knowingly or recklessly to make a false statement in connection with an application, the maximum fine for which on summary conviction is £5,000.

'LITTLE EUROPE'
715 LINCOLN ROAD
PETERBOROUGH
PE1 3HD

SCALE 1:100

14TH FEBRUARY 2018.

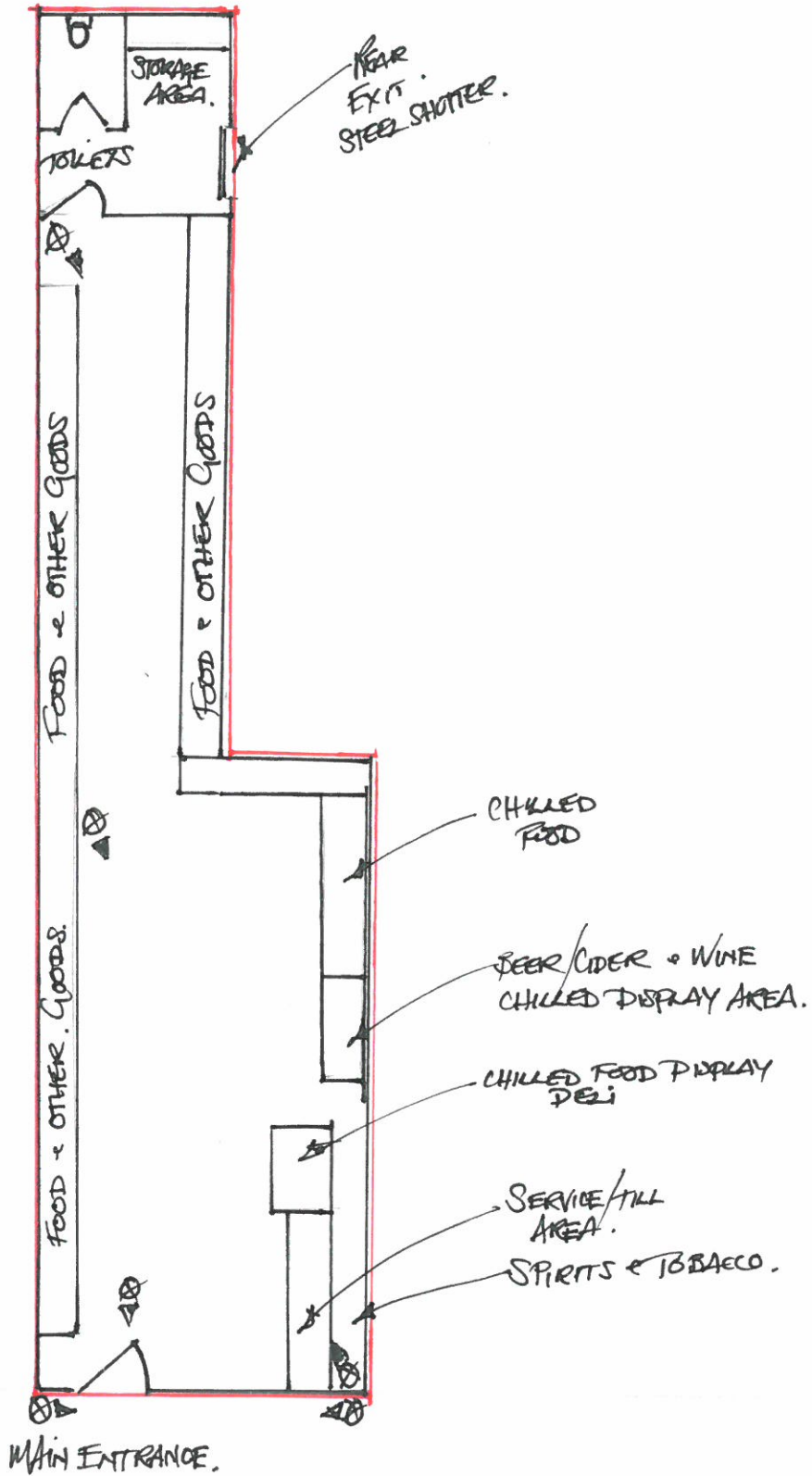

This page is intentionally left blank

The Licensing Team
Peterborough City Council
Bayard Place
Peterborough

23rd February 2018

Dear Sir/Madam

Application for a Premises License 076866

Premises Name: Little Europe

Premises Address: 715 Lincoln Road, Peterborough PE1 3HD

I am the Chair of Millfield & New England Regeneration Partnership (MANERP) which represents residents who live in the Millfield and New England areas of Peterborough. The reason for writing is to request that the application for a Premises License be refused.

The Millfield and New England area of Peterborough has had for several years a history of anti-social behaviour fuelled by alcohol and drug abuse. This has been exacerbated by the rapid growth of a number of outlets retailing alcohol by means of “off-sales.”

The area is also within the boundary of the “Can-Do” initiative which has brought together the city council, police, NHS, Resident Associations and other partner agencies to jointly combat the serious issues being faced in this area.

It must also be noted that the area was made a Cumulative Impact Zone whereby the applicant needs to prove that there is a need for selling alcohol “off sales”. The premises in this application is in close proximity to other shops retailing “off-sales” alcohol and cannot therefore, prove that there is a need.

The whole area is very sensitive and volatile because of the ease of access to the purchase of alcohol often sold at a low price in order to attract customers or to be competitive.

As the Millfield and New England area has a phenomenal number of outlets selling alcohol “off-sales” (around the seventy plus mark) which has contributed significantly to anti-social behaviour in the area. The current joint partnership between Peterborough City Council, Cambridgeshire Police and other partner agencies through the “Can-Do” initiative has highlighted the need to reduce the number of outlets and hours that alcohol can be freely

purchased, if it is to make any headway towards the goals that it is striving to achieve.

With this and the Cumulative Impact Policy in mind, we also make this representation under all of the Licensing Objectives set out in the Licensing Act 2003, namely;

- a) The prevention of crime and disorder
- b) Public safety
- c) The prevention of public nuisance
- d) Protection of children from harm

The MANERP's primary aim is to try to regenerate an area that has been sadly neglected for many years. The largest single problem of all revolves around the ease, low cost but above all, availability at which alcohol can be purchased and subsequently abused. The impact on the area is huge and is a cause of concern for all the statutory agencies and bodies.

We therefore ask that this application be refused by the Licensing Committee for the reasons stated above.

Yours Sincerely

BRIAN W J GASCOYNE BEM
Chair - Millfield and New England Regeneration Partnership

